

Color Monitor - Kit Structure

Color Monitor (PN 3847822)

Note
Plastic template should be used to help determine clearance around mounting area. Once clearance has been verified, use template to drill and cut holes for display mounting.

Map slot

Note
Kit includes mounting hardware and plastic drilling/cutout template.
Map card is included with optional GPS Kit.

A **B**
C **D**

GPS Kit (PN 3849222)

X 2

X 2

Note
Optional detailed area upgrades for map cards may be purchased at any Navionics dealer.

NMEA Backbone Kit (PN 3849223)

X 2

Multisensor Kit (PN 3849224)

EVC Kit (PN 3847653)

X 2

X 2

**Cable Harness (PN 3847825)
Single Engine Application or Port Side in Twin Engine Application**

Four wires

Four wires

**Cable Harness (PN 3847826)
Starboard Side in Twin Engine Application**

Two wires

Two wires

Gimbal Mount (PN 3849235)

Mounting flange on display unit fits between bolt and washer

Note
Mounting method and hardware used depend on mounting surface. May be mounted using lag bolts or, if surface is not thick enough, using nuts and bolts.
Also, a "pass-through" hole will need to be cut out for all cables running up to the display. Hole should be located behind the gimbal mount to partially hide any cables.

Mounting Instructions

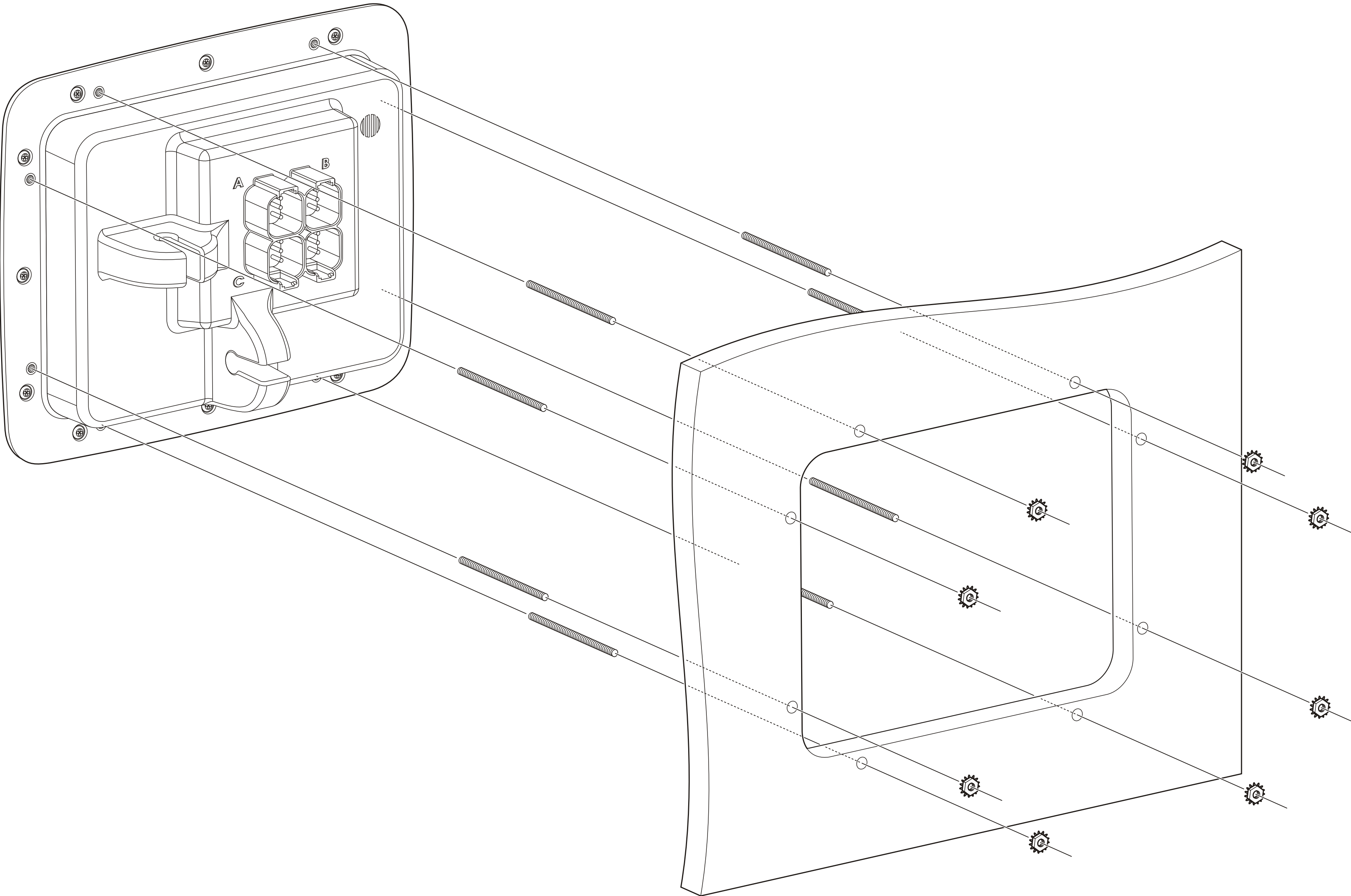

Mounting Instructions

(continued from reverse side)

Cable Harness: Non-EVC application

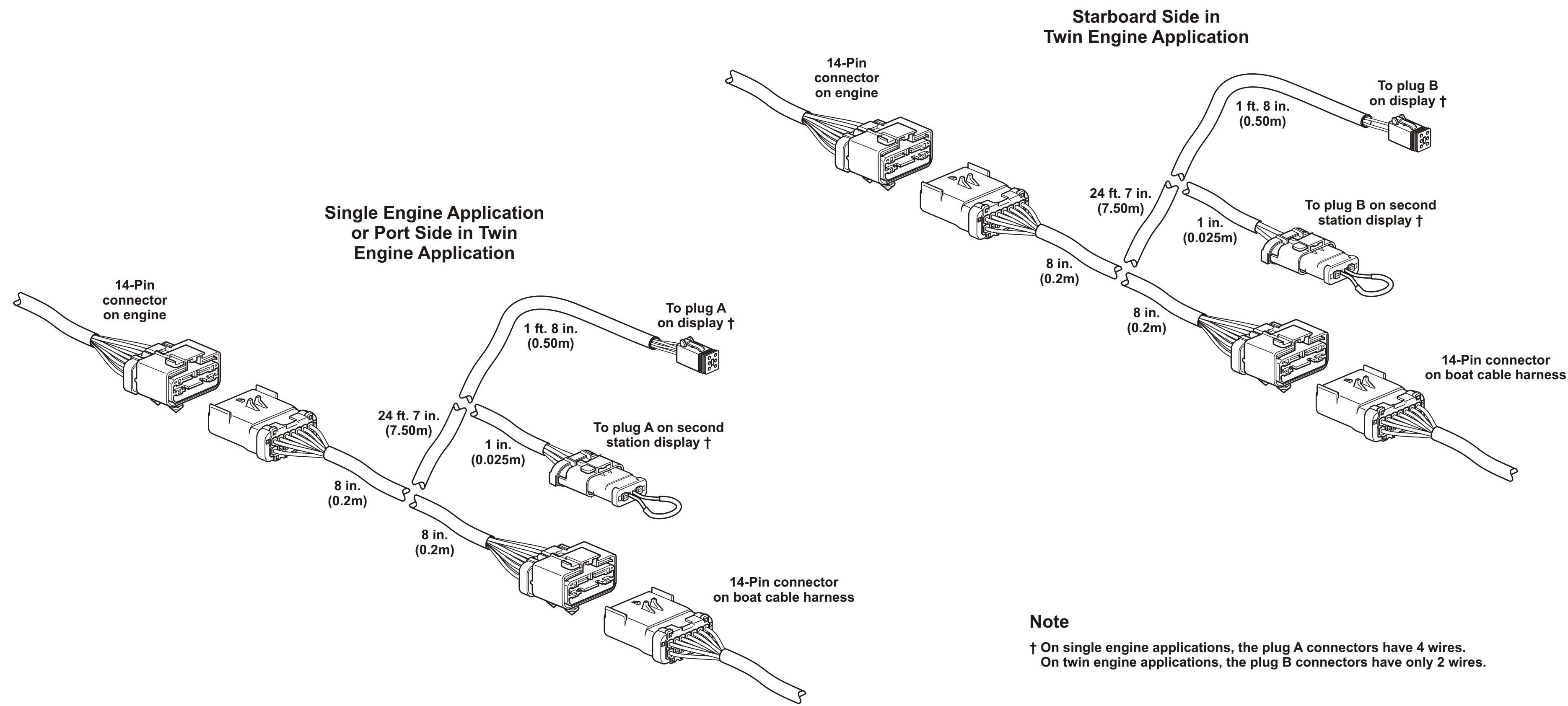

Non-EVC Application

† White and brown to 12 Volt (+) power source
Black and blue to 12 Volt (-) ground
Gray shield to 12 Volt (-) ground

Please refer to NMEA standards for fusing specifications.

‡ Length of cables leading from T-connectors to components must be 3 meters or less.

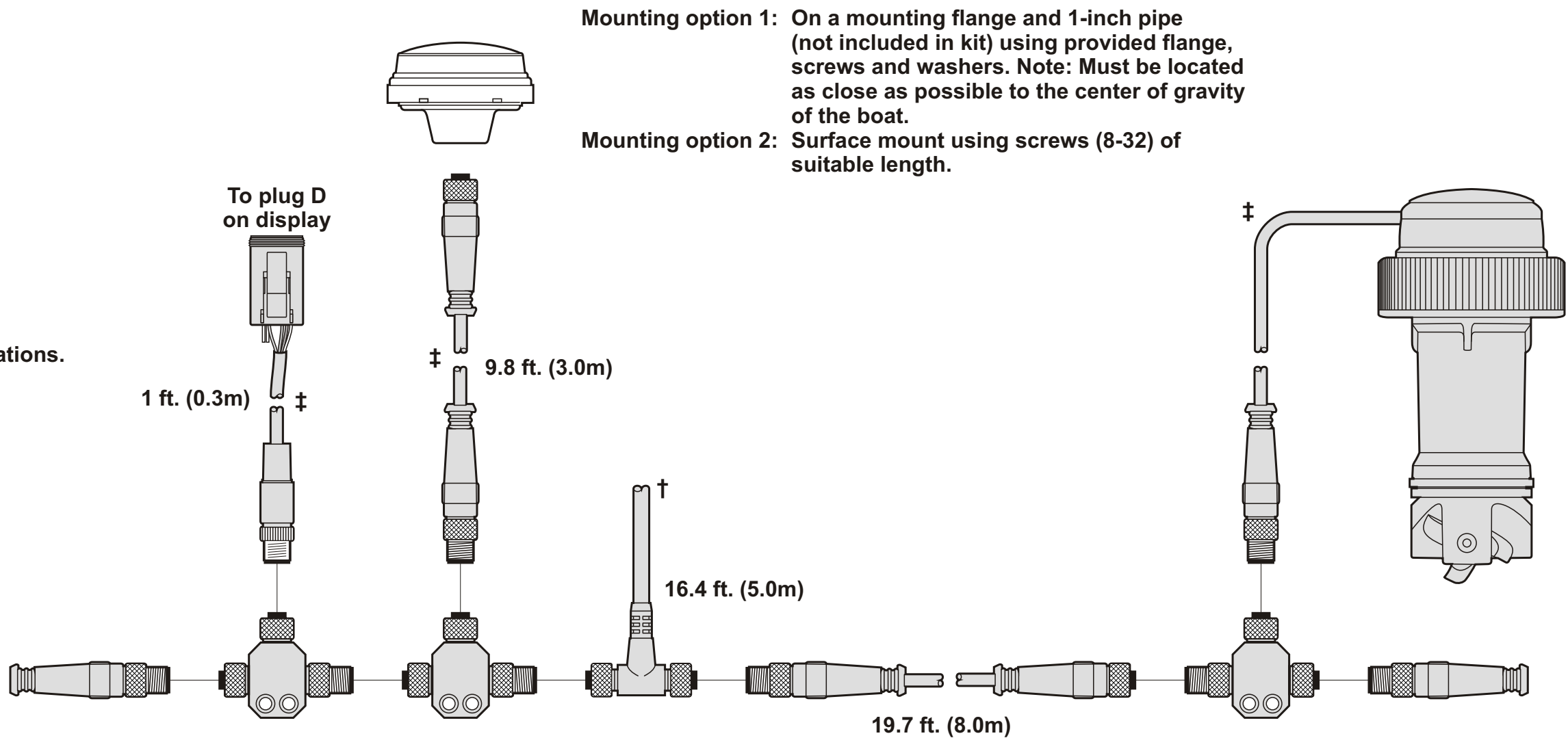

EVC Application

To plug A on display

3.3 ft. (1.0m)

1 2

1: Black - Accessory Ground
2: Red - EVC Accessory Relay (Power)

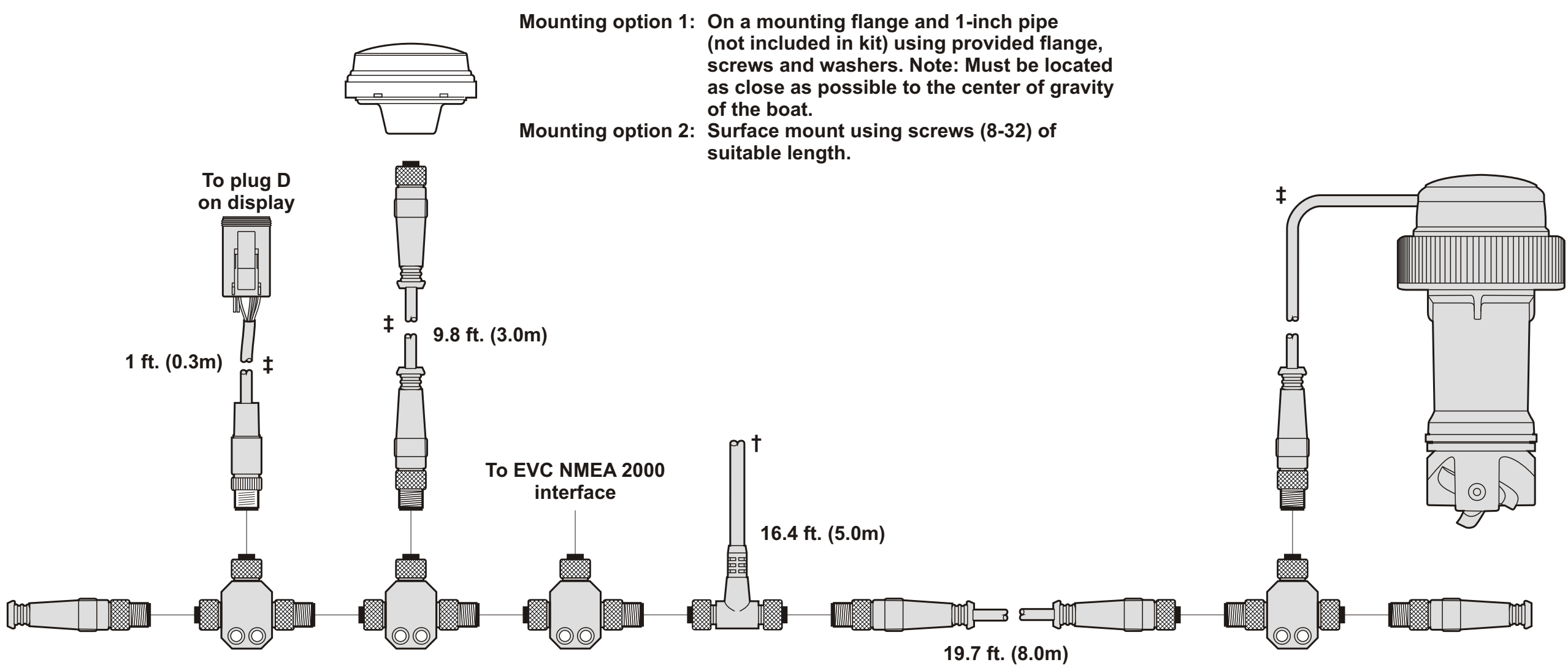

Software Requirements

Once all the components have been properly connected, follow the steps below to complete the EVC installation:

1. Using the display, navigate to *Utilities > System Settings*.
2. Using the **SCROLL DOWN** button, change the *Wiring Config* selection to "NMEA – Plug D – Port, Stbd."
3. Press the **Save** button.

† White and brown to 12 Volt (+) power source
Black and blue to 12 Volt (-) ground
Gray shield to 12 Volt (-) ground

Please refer to NMEA standards for fusing specifications.

‡ Length of cables leading from T-connectors to components must be 3 meters or less.

INSTALLER: PLEASE ENSURE THAT THE VOLVO PENTA COLOR MONITOR OPERATOR'S MANUAL (SUPPLIED WITH DISPLAY KIT) AND THIS POSTER ARE INCLUDED IN THE BOAT LITERATURE PACK